

Connecting the Oceans

KEY: † Military Cemetery



President Theodore Roosevelt controls a steam shovel while inspecting Panama Canal construction, November 1906.

American Battle Monuments Commission

This agency of the United States government operates and maintains 26 American cemeteries and 30 memorials, monuments and markers in 17 countries. The Commission works to fulfill the vision of its first chairman, General of the Armies John J. Pershing. Pershing, commander of the American Expeditionary Forces during World War I, promised that "time will not dim the glory of their deeds."

Corozal American Cemetery and Memorial

The site was originally a farm of the Isthmian Canal Commission. It evolved into a cemetery in 1914, expanding over the years. Under terms of the Panama Canal Treaty, ratified in 1978, 16.9 acres of the site was designated a permanent American cemetery. ABMC assumed control of the site on June 5, 1982.

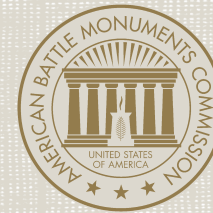

American Battle Monuments Commission
2300 Clarendon Boulevard
Suite 500
Arlington, VA 22201
USA

Corozal American Cemetery
Calle Rufina Alfaro, Edif. #6566
Corozal
Republic of Panama
TEL 011-507-317-6034
EMAIL Corozal@abmc.gov
GPS N8 59.356 W79 34.351

For more information on this site and other
ABMC commemorative sites, please visit
www.abmc.gov

November 2018



ENGLISH

AMERICAN BATTLE MONUMENTS COMMISSION

Corozal American Cemetery and Memorial



"Time will not dim the glory of their deeds."

- General of the Armies John J. Pershing

CONNECTING THE OCEANS

DECEMBER 1502: Christopher Columbus, on his fourth voyage, saw the Chagres River.

1509: Spain founded settlements in Panama.

SEPTEMBER 1513: Vasco Nuñez de Balboa reached the Pacific Ocean and proved the isthmus existed.

NOVEMBER 25, 1821: Panama declared independence from Spain, joining Colombia.

JANUARY 27, 1855: Panama Railroad, the first transcontinental railroad, was completed.

NOVEMBER 3, 1903: With U.S. encouragement, Panama seceded from Colombia.

NOVEMBER 18: The U.S. and Panama signed the Hay—Bunau-Varilla Treaty, granting the U.S. rights to build and defend a canal across the isthmus.

MAY 4, 1904: The Isthmian Canal Commission began construction of the Panama Canal.

NOVEMBER 6-22, 1906: President Theodore Roosevelt inspected the Panama Canal construction on the first official visit abroad by a president while in office.

FEBRUARY 5, 1914: The Isthmian Canal Commission designated two acres of land as a permanent cemetery. The first interment was conducted on February 13.

AUGUST 15: The Panama Canal officially opened, connecting the oceans.

SEPTEMBER 7, 1977: President Jimmy Carter and General Omar Torrijos signed the two Torrijos-Carter Treaties, transferring the Canal to Panama by the end of the 20th Century.

JANUARY 19, 1979: President Carter's Executive Order 12115 assigned the American Battle Monuments Commission to administer the 16.9-acre Corozal American Cemetery.

JUNE 5, 1982: ABMC assumed control of the cemetery.

JUNE 11, 1999: The U.S. and Panama signed the agreement formalizing ABMC's operation of the cemetery after the Panama Canal and U.S. bases were transferred to Panama on December 31, 1999.

Overview

This aerial photo highlights the various plot areas.



Graves Area

The graves are situated on the rolling terrain of the cemetery in 11 plots ranging alphabetically from A through K.



Memorial

The inscription on the memorial pays tribute to those interred here who served in the U.S. armed forces or contributed to the construction, operation and maintenance of the Panama Canal.



Headstone

SGT Albert W. Covington is one of more than 50 Spanish-American War veterans interred at this cemetery. In 1901, he volunteered for Yellow Fever experimental tests, which led to a vaccine.



Visitor Building

Here you can meet our staff, get your questions answered, view our historical displays, and sign the guest register.



Public Ceremonies

Two ceremonies are held annually, Memorial Day in May and Veteran's Day in November. The events are free and open to the public.

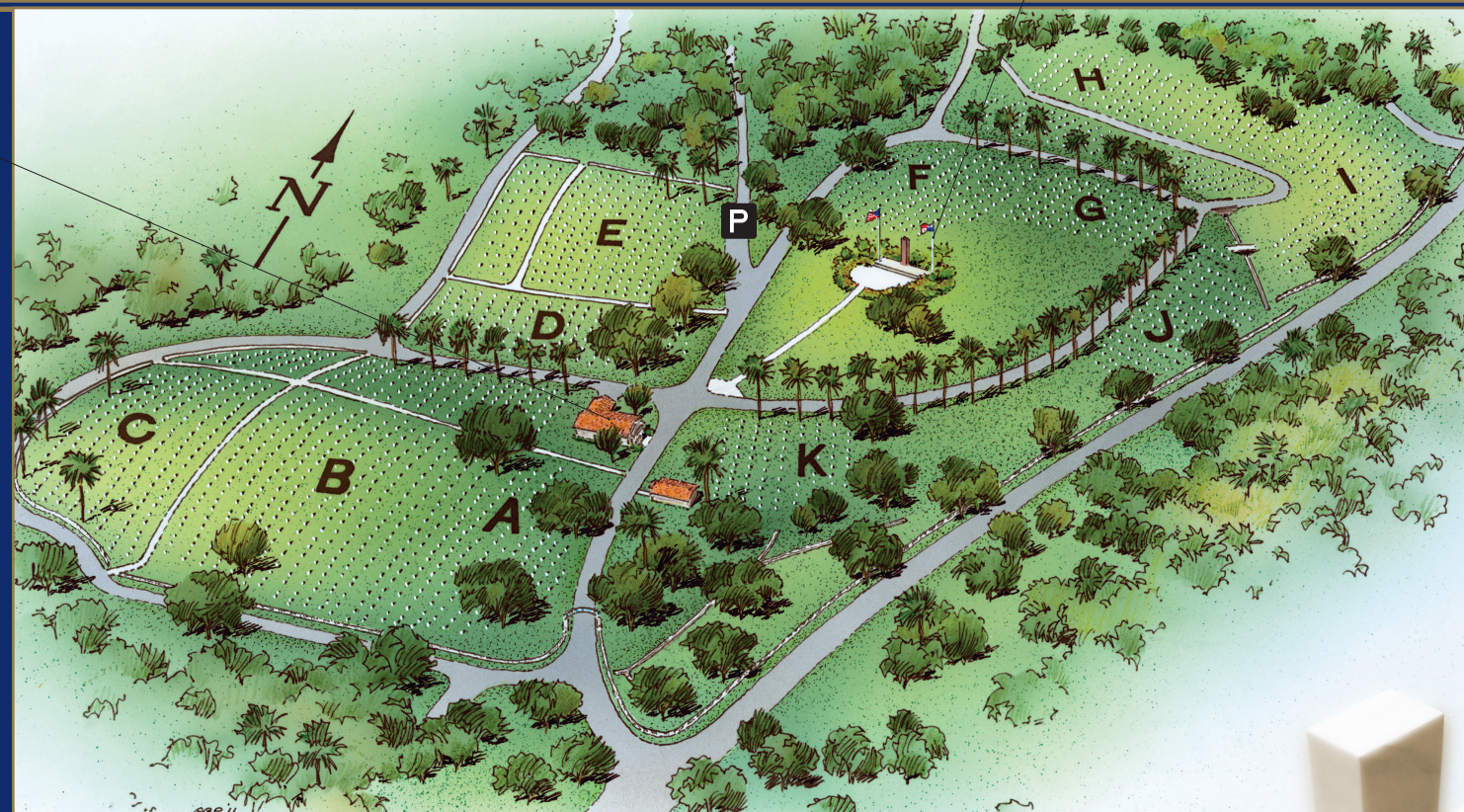

Layout

After passing through the entrance gate, visitors follow a path with restrooms on the right and then the visitor building on the left. Parking is available at the "Y" at the base (east) of section E.

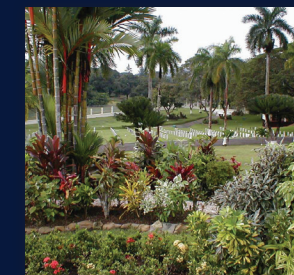

Plantings

Lush tropical flowers and other plantings brighten the scene. Stately palm trees enhance the dignity of the site.



Workers pause during construction of a "cut" through terrain for the Panama Canal, 1913.

Headstone Location

PLOT:

ROW:

GRAVE:

Useful Information

DIMENSIONS: 16.9 acres
NUMBER INTERRED: 5,490
NATIONALITIES REPRESENTED: 70
DEDICATED: February 5, 1914

U.S. ACTIONS INVOLVED: Construction and security of the Panama Canal, campaigns from the Mexican-American War and the American Civil War through the Global War on Terror.

